

FLOOR PLANS & *Site Map*

	Dimensions	Square Feet	Ceiling Height	Banquet	Theatre	Class-room	Reception	8'x10' Booths
Carriage Hall	180'x72'	12,960	13'7"	1,000/750	1,200	800	1,200	88
<i>Divided: A</i>	120'x72'	8,640	13'7"	640/400	850	520	750	58
<i>Divided: B</i>	60'x72'	4,320	13'7"	320/200	350	240	350	26
<i>Pre-function</i>	Varies	4,343	7'10"	-	-	-	300	9
<i>Dock Area</i>	37'x24'	875	-	-	-	-	-	-
Captain's	56'x38'	2,128	16'	150/110	184	128	215	12
<i>Pre-function</i>	Varies	1,492	9'	-	30	-	50	3
The Loft	36'x18' 15'x11'	813	-	Fixed	Fixed	Fixed	Fixed	-
Garden City Ballroom	95'x49'	4,631	13'	330/250	330	256	330	30
<i>Pre-function</i>	41'x30'	1,230	8'	-	-	-	-	4
Harvest Room	96'x47'	4,512	8'/13'	300/230	300	264	300	-
<i>Divided: A</i>	47'x42'	1,974	8'/13'	120	160	112	200	-
<i>Divided: B</i>	47'x28'	1,316	8'/13'	80	100	64	170	-
<i>Divided: C</i>	47'x26'	1,222	8'/13'	60	80	40	100	-
<i>Pre-function</i>	96'x20' 41'x14'	2,494	8'	-	-	-	200	-
Lower Level								
Morgan	40'x16'	640	10'	30	56	24	60	-
Tack	78'x36'	2,808	10'	200/140	288	188	273	20
<i>Divided: A</i>	42'x36'	1,512	10'	100	146	80	156	-
<i>Divided: B</i>	36'x36'	1,296	10'	90	130	80	128	-
<i>Pre-function</i>	135'x8'	1,080	10'	-	-	-	-	-
Inn/Retreat Area								
Earle's Room	16'x15'	240	Fixed Boardroom for 16					-
Gwen's Room	17'x15'	255	Fixed Boardroom for 12					-
Sunroom	31'x12'	372	Fixed Boardroom for 24					-
Parlor	28'x16'	448	-	40	-	-	40	-
Outdoors								
Courtyard	423'x191'	80,793	-	-	-	-	3,000	-
Parking Lot	Varies	-	297 Parking Spaces		-	-	-	-
Parking Lot Overflow	355'x316'	112,180	350 Parking Spaces		-	-	-	-

NOTE: Capacities listed are maximums for each room. Use of staging, dance floor or audio/visual equipment may decrease stated maximum capacities for each room. Sales staff will assist you in determining the best fit for your event.

Special Features

- ☞ Over 40,000 square feet of unique conference and event spaces
- ☞ Flexible, experienced, and accommodating staff
- ☞ Located on a historic and beautifully restored site, featuring courtyard and immaculate landscaping
- ☞ Superb audio/visual capabilities, including flexible sound system to accommodate multi-room layouts
- ☞ Complete catering services provided on-site
- ☞ Easy access from I-94/694 or Highway 100
- ☞ Plentiful free parking on-site
- ☞ 10 minutes from downtown Minneapolis
- ☞ 25 minutes from downtown St. Paul
- ☞ 25 minutes from the Minneapolis/St. Paul International Airport
- ☞ Airport shuttle service provided by surrounding nearby hotels
- ☞ Service by 13 major airlines and 9 regional airlines, with 900 incoming and outgoing flights daily
- ☞ 1,800 hotel rooms, in every price range, within five-minute radius
- ☞ Connected to hotel
- ☞ Free wireless Internet



LOWER LEVEL

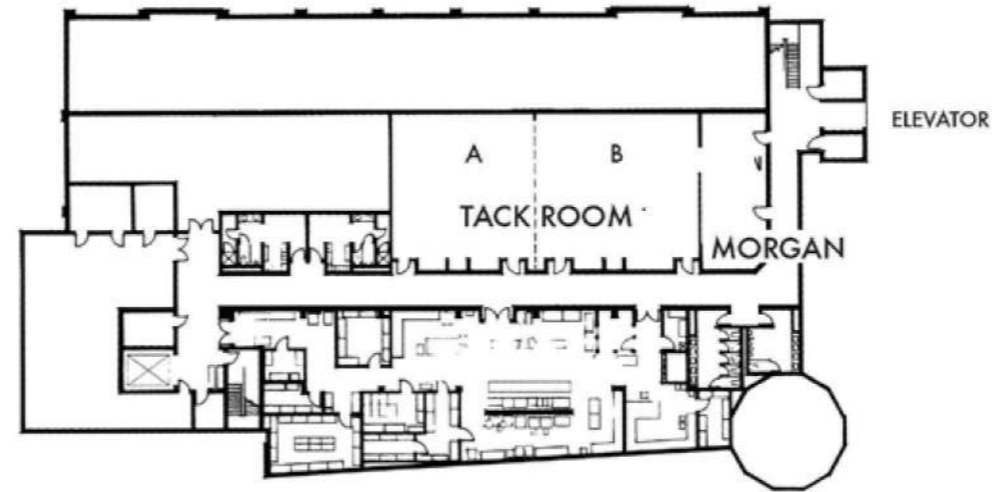

SECOND LEVEL LOFT

